

WJB 行程軸承：ST-(UU)

Ordinary type: ST...(UU)

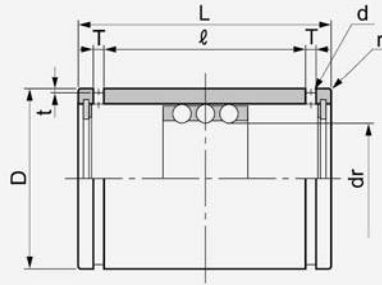

ST-(UU)



型號 Model	最大行程 Maximum stroke mm	鋼球列數 Number of rows	主要尺寸和公差 Major dimensions and tolerance											額定負荷 Basic load rating		重量 Weight (g)
			dr		D		L		ℓ	T	t	d	r	動負荷 Dynamic C N	靜負荷 Static Co N	
			mm	公差 Tolerance μm	mm	公差 Tolerance μm	mm	公差 Tolerance μm								
ST 6	20	3	6		12	0	20		11.3	1.1	0.5	1	0.5	216	147	8.9
ST 8	24	3	8	+22 +13	15	-11	24		17.1	1.5	0.5	1.2	0.5	343	245	15.6
ST 10	30	3	10		19		30	0	22.7	1.5	0.5	1.2	0.5	637	461	28.8
ST 12	32	3	12	+27 +16	23	-13	32	-200	24.5	1.5	0.5	1.2	0.5	1,070	813	42
ST 16	40	3	16		28		37		29.1	1.5	0.7	1.3	0.5	1,180	990	71
ST 20	50	3	20		32		45		35.8	2	0.7	1.5	0.5	1,260	1,170	99
ST 25	50	3	25	+33 +20	37	0 -16	45		35.8	2	0.7	1.6	1	1,330	1,330	117
ST 30	82	3	30		45		65		53.5	2.5	1	2	1	2,990	3,140	205
ST 35	92	3	35		52		70	0	58.5	2.5	1	2	1.5	3,140	3,530	329
ST 40	108	3	40	+41 +25	60	0 -19	80	-300	68.3	2.5	1	2	1.5	4,120	4,800	516
ST 50	138	3	50		72		100		86.4	3	1	2.5	1.5	5,540	6,910	827
ST 60	138	3	60	+49 +30	85	0 -22	100		86.4	3	1	2.5	2	5,980	8,230	1,240
ST 80	132	3	80		110		100	0	86	3	1.5	2.5	2	7,840	12,200	2,050
ST100	132	3	100	+58/+36	130	0/-25	100	-400	86	3	1.5	2.5	2	8,430	14,700	2,440

1N=0.102kgf