

WJB 銅自潤軸承 (特殊規格尺寸可依圖訂製) 特殊銅合金系

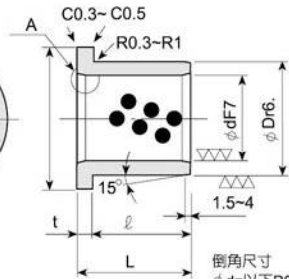
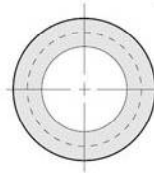
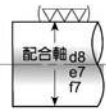

自潤#500SP 襯套(SPF)

迴轉(搖擺)· 往復運動用

●配合軸
d8：一般用(高負荷)
e7：一般用(輕負荷)
f7：高精度用

倒角尺寸
φd=以下R0.3
φd=以下R0.5
φd=以上R1

軸徑 區分	尺寸 (mm)						長度 L					公差 ^{-0.1} _{-0.3}		
	內徑		外徑		凸緣		10	15	20	25	30	35		
	φd	公差	φD	公差	徑φF	厚度	公差	SPF	SPF	SPF	SPF	SPF	SPF	SPF
10	10	+0.040 +0.025	14	+0.034 +0.023	22	2	0 -0.1	-1010	-1015	-1020				
12	12	+0.050 +0.032	18	"	25	3	"	-1210	-1215	-1220	-1225	-1230		
13	13	"	19	+0.041 +0.028	26	"	"		-1315	-1320				
14	14	"	20	"	27	"	"		-1415	-1420	-1425			
15	15	"	21	"	28	"	"	-1510	-1515	-1520	-1525	-1530		
16	16	"	22	"	29	"	"		-1615	-1620	-1625	-1630	-1635	
20	20	+0.061 +0.040	30	"	40	5	"		-2015	-2020	-2025	-2030		
25	25	"	35	+0.050 +0.034	45	"	"		-2515	-2520	-2525	-2530	-2535	
30	30	"	40	"	50	"	"			-3020	-3025	-3030	-3035	
31.5	31.5	+0.075 +0.050	40	"	"	"	"			-3120		-3130	-3135	
35	35	"	45	"	60	"	"			-3520	-3525	-3530	-3535	
40	40	"	50	"	65	"	"			-4020	-4025	-4030	-4035	
45	45	"	55	+0.073 +0.041	70	"	"					-4530	-4535	
50	50	"	60	"	75	"	"					-5030	-5035	
55	55	+0.090 +0.060	65	"	80	"	"							
60	60	"	75	+0.062 +0.043	90	7.5	"							
63	63	"	75	"	85	"	"							
70	70	"	85	+0.083 +0.051	105	"	"							
75	75	"	90	"	110	"	"							
80	80	"	100	"	120	10	"							
90	90	+0.107 +0.072	110	+0.076 +0.054	130	"	"							
100	100	"	120	"	150	"	"							
120	120	"	140	+0.088 +0.063	170	"	"							

使用注意事項

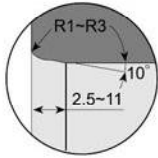

- 自潤#500SP襯套(SPF)在迴轉，搖擺及往復運動均可使用。
- 請注意凸緣部無固體潤滑劑。
- 請避免在水中使用。
- 內徑31.5mm在油壓缸中間耳軸(trunnion)襯套。

訂購型號

SPF - \bigcirc \bigcirc \bigcirc \bigcirc
 內徑 長度

		長 度 L			公差 ^{0.1} _{0.3}		內 徑	外 徑
		40	50	60	67.5	80	100	
		SPF	SPF	SPF	SPF	SPF	SPF	
								10 14
								12 18
								13 19
								14 20
								15 21
								16 22
								20 30
								25 35
								30 40
								31.5 40
								35 45
								40 50
								45 55
								50 60
								55 65
								60 75
								63 75
								70 85
								75 90
								80 100
								90 110
								100 120
								120 140